

Operator
Telephone
Fax
e-Mail

1000W Halogen flood light SYMMETRIC_WIDE_BEAM / Luminaire Data Sheet

See our luminaire catalog for an image of the luminaire.



Luminous emittance 1:

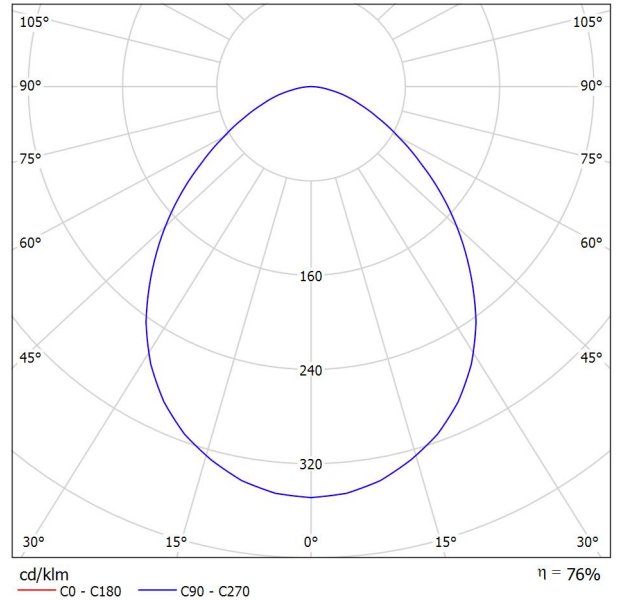

Luminaire classification according to CIE: 100
CIE flux code: 57 86 97 100 76

Luminous emittance 1:

Glare Evaluation According to UGR											
ρ Ceiling	70	70	50	50	30	70	70	50	50	30	
ρ Walls	50	30	50	30	30	50	30	50	30	30	
ρ Floor	20	20	20	20	20	20	20	20	20	20	
Room Size X Y	Viewing direction at right angles to lamp axis					Viewing direction parallel to lamp axis					
2H	2H	34.5	35.7	34.8	35.9	36.1	34.9	36.1	35.2	36.3	36.5
	3H	35.2	36.2	35.5	36.5	36.7	35.6	36.7	35.9	36.9	37.2
	4H	35.4	36.4	35.7	36.6	36.9	35.9	36.9	36.2	37.1	37.4
	6H	35.4	36.4	35.8	36.7	37.0	36.0	36.9	36.3	37.2	37.5
	8H	35.5	36.3	35.8	36.6	37.0	36.0	36.9	36.4	37.2	37.5
12H	35.4	36.3	35.8	36.6	36.9	36.0	36.8	36.4	37.2	37.5	
4H	2H	34.8	35.8	35.2	36.1	36.4	35.2	36.2	35.5	36.5	36.7
	3H	35.6	36.5	36.0	36.8	37.1	36.0	36.9	36.4	37.2	37.5
	4H	35.9	36.6	36.3	37.0	37.4	36.3	37.1	36.7	37.4	37.8
	6H	36.1	36.7	36.5	37.1	37.5	36.5	37.2	36.9	37.6	37.9
	8H	36.1	36.7	36.5	37.1	37.5	36.6	37.2	37.0	37.6	38.0
12H	36.1	36.6	36.5	37.0	37.5	36.6	37.1	37.0	37.5	38.0	
8H	4H	36.0	36.6	36.4	37.0	37.4	36.4	37.0	36.8	37.4	37.8
	6H	36.2	36.7	36.6	37.1	37.5	36.6	37.1	37.1	37.5	38.0
	8H	36.2	36.7	36.7	37.1	37.6	36.7	37.1	37.2	37.6	38.0
	12H	36.3	36.6	36.7	37.1	37.6	36.7	37.1	37.2	37.6	38.1
	12H	4H	36.0	36.5	36.4	36.9	37.3	36.4	36.9	36.8	37.3
6H		36.2	36.6	36.7	37.0	37.5	36.6	37.0	37.1	37.5	38.0
8H		36.2	36.6	36.7	37.1	37.6	36.7	37.1	37.2	37.5	38.0
Variation of the observer position for the luminaire distances S											
S = 1.0H	+0.3 / -0.5					+0.3 / -0.4					
S = 1.5H	+0.6 / -1.2					+0.7 / -1.0					
S = 2.0H	+1.5 / -2.0					+1.6 / -1.9					
Standard table	BK03					BK03					
Correction Summand	17.7					18.1					
Corrected Glare Indices referring to 21500lm Total Luminous Flux											

Operator
 Telephone
 Fax
 e-Mail

Exterior Scene 1 / Planning data

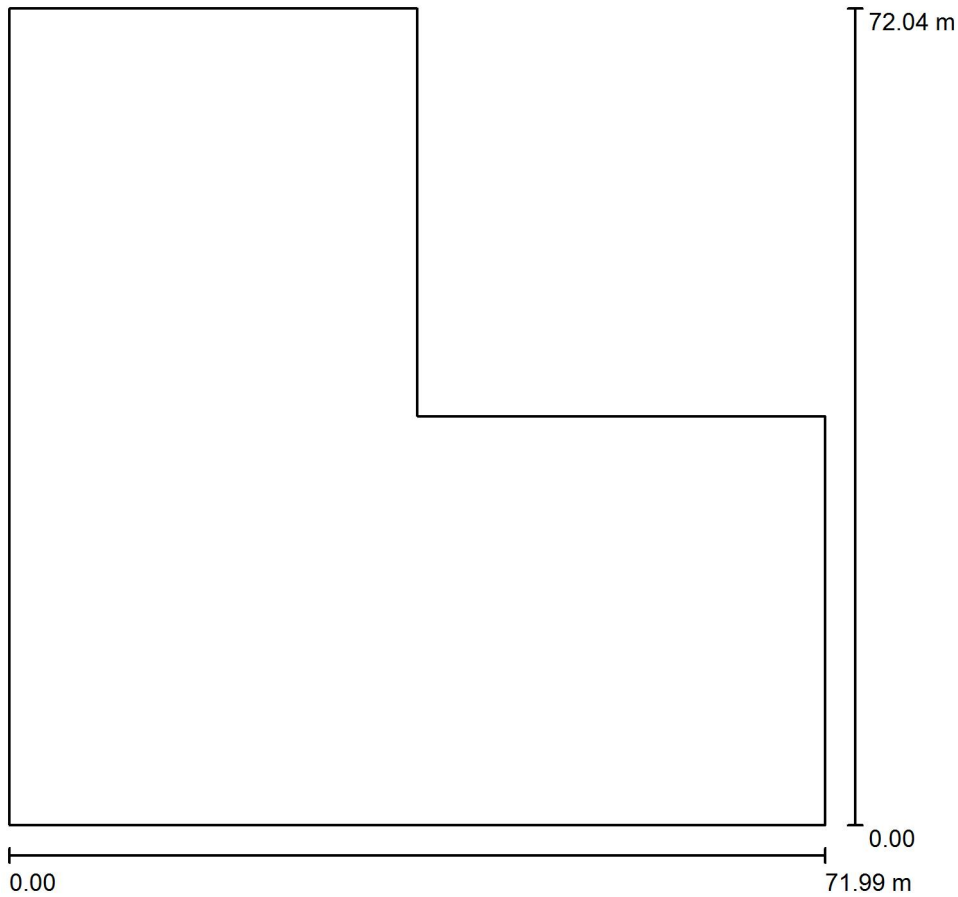

Light loss factor: 0.80, ULR (Upward Light Ratio): 20.0%

Scale 1:668

Luminaire Parts List

No.	Pieces	Designation (Correction Factor)	Φ (Luminaire) [lm]	Φ (Lamps) [lm]	P [W]
1	120	1000W Halogen flood light SYMMETRIC_WIDE_BEAM (1.000)	16257	21500	1000.0
Total:			1950886	Total: 2580000	120000.0

Operator
 Telephone
 Fax
 e-Mail

Exterior Scene 1 / Luminaires (layout plan)

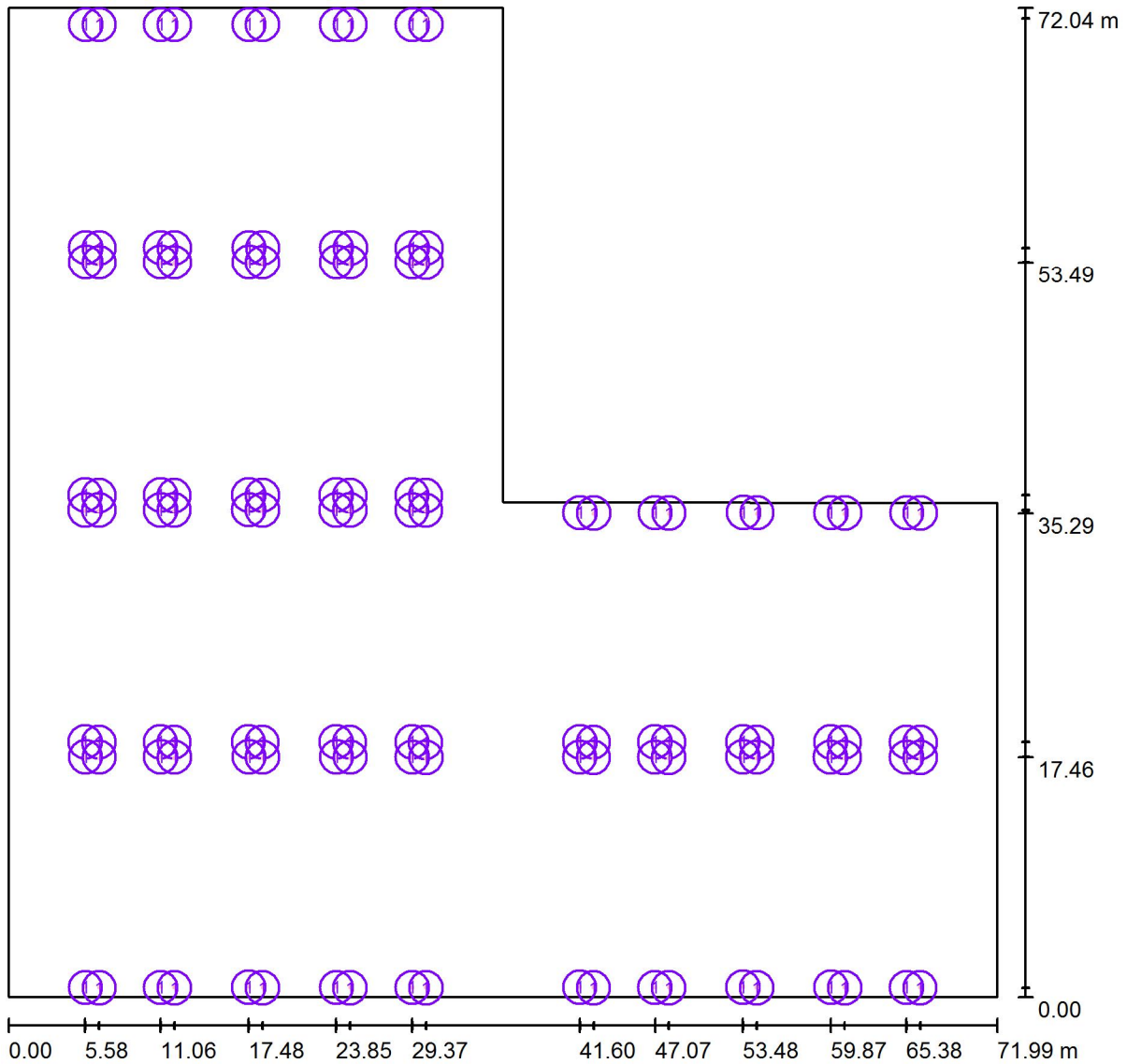

Scale 1 : 515

Luminaire Parts List

No.	Pieces	Designation
1	120	1000W Halogen flood light SYMMETRIC_WIDE_BEAM

Operator
Telephone
Fax
e-Mail

Exterior Scene 1 / Pole Positions (Coordinates List)

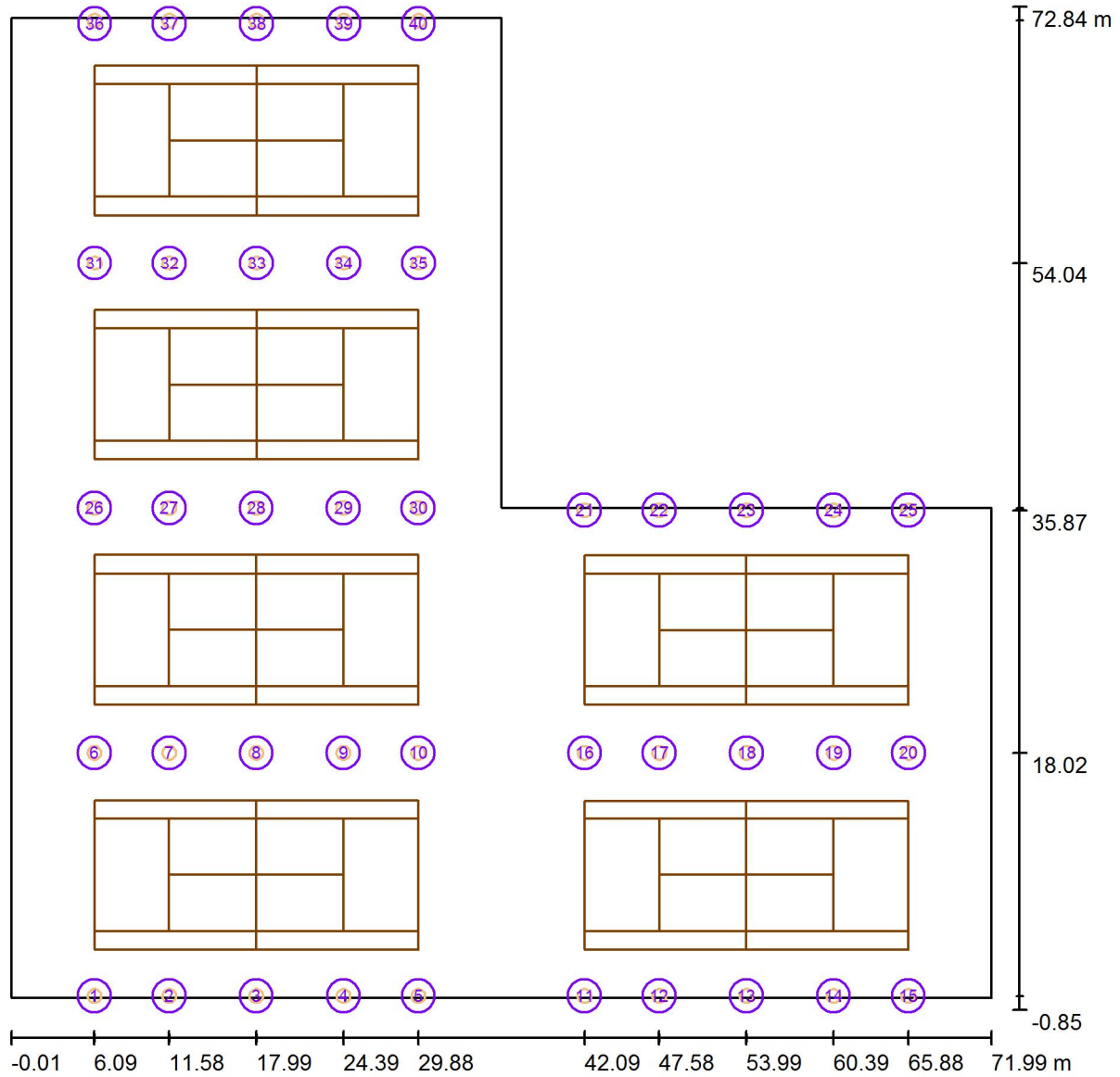

Scale 1 : 515

List of the Pole Positions

No.	Designation	Position [m]		
		X	Y	Z
1	(x) Pole Position	6.102	0.146	0.000
2	(x) Pole Position	11.589	0.146	0.000
3	(x) Pole Position	17.993	0.146	0.000
4	(x) Pole Position	24.396	0.146	0.000

Operator
Telephone
Fax
e-Mail

Exterior Scene 1 / Pole Positions (Coordinates List)

List of the Pole Positions

No.	Designation	Position [m]		
		X	Y	Z
5	(x) Pole Position	29.890	0.146	0.000
6	(x) Pole Position	6.094	18.025	0.000
7	(x) Pole Position	11.581	18.025	0.000
8	(x) Pole Position	17.988	18.025	0.000
9	(x) Pole Position	24.388	18.025	0.000
10	(x) Pole Position	29.882	18.025	0.000
11	(x) Pole Position	42.095	0.146	0.000
12	(x) Pole Position	47.583	0.146	0.000
13	(x) Pole Position	53.986	0.146	0.000
14	(x) Pole Position	60.390	0.146	0.000
15	(x) Pole Position	65.884	0.146	0.000
16	(x) Pole Position	42.106	18.025	0.000
17	(x) Pole Position	47.593	18.025	0.000
18	(x) Pole Position	54.000	18.025	0.000
19	(x) Pole Position	60.400	18.025	0.000
20	(x) Pole Position	65.895	18.025	0.000
21	(x) Pole Position	42.095	35.869	0.000
22	(x) Pole Position	47.582	35.869	0.000
23	(x) Pole Position	53.989	35.869	0.000
24	(x) Pole Position	60.389	35.869	0.000
25	(x) Pole Position	65.884	35.869	0.000
26	(x) Pole Position	6.096	36.045	0.000
27	(x) Pole Position	11.583	36.045	0.000
28	(x) Pole Position	17.990	36.045	0.000
29	(x) Pole Position	24.390	36.045	0.000
30	(x) Pole Position	29.885	36.045	0.000
31	(x) Pole Position	6.120	54.044	0.000
32	(x) Pole Position	11.608	54.044	0.000
33	(x) Pole Position	18.015	54.044	0.000
34	(x) Pole Position	24.415	54.044	0.000
35	(x) Pole Position	29.909	54.044	0.000
36	(x) Pole Position	6.115	71.836	0.000
37	(x) Pole Position	11.602	71.836	0.000
38	(x) Pole Position	18.009	71.836	0.000
39	(x) Pole Position	24.409	71.836	0.000
40	(x) Pole Position	29.904	71.836	0.000

Operator
Telephone
Fax
e-Mail

Exterior Scene 1 / 3D Rendering

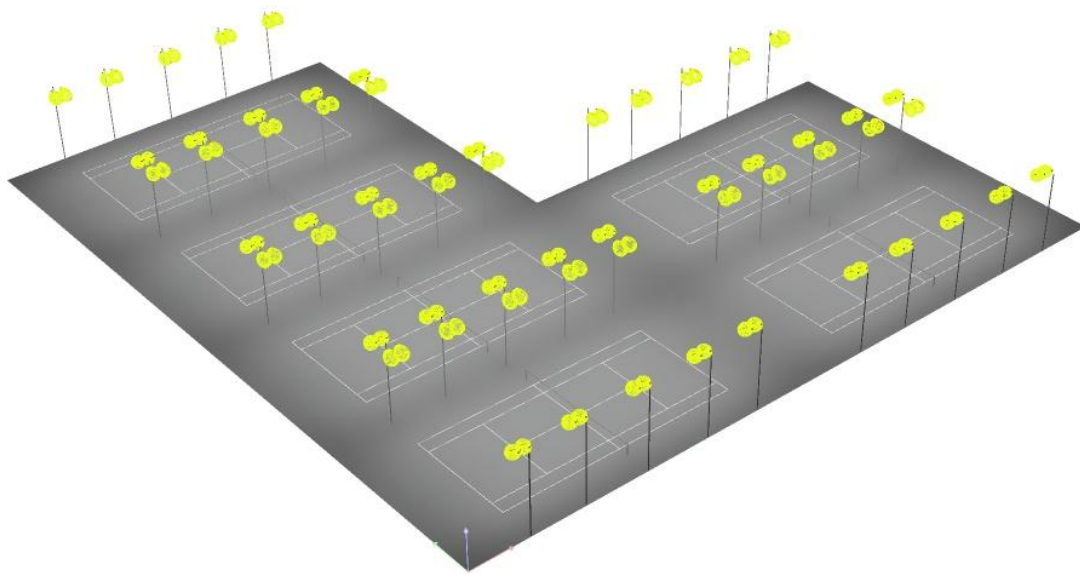

Operator
Telephone
Fax
e-Mail

Exterior Scene 1 / False Color Rendering

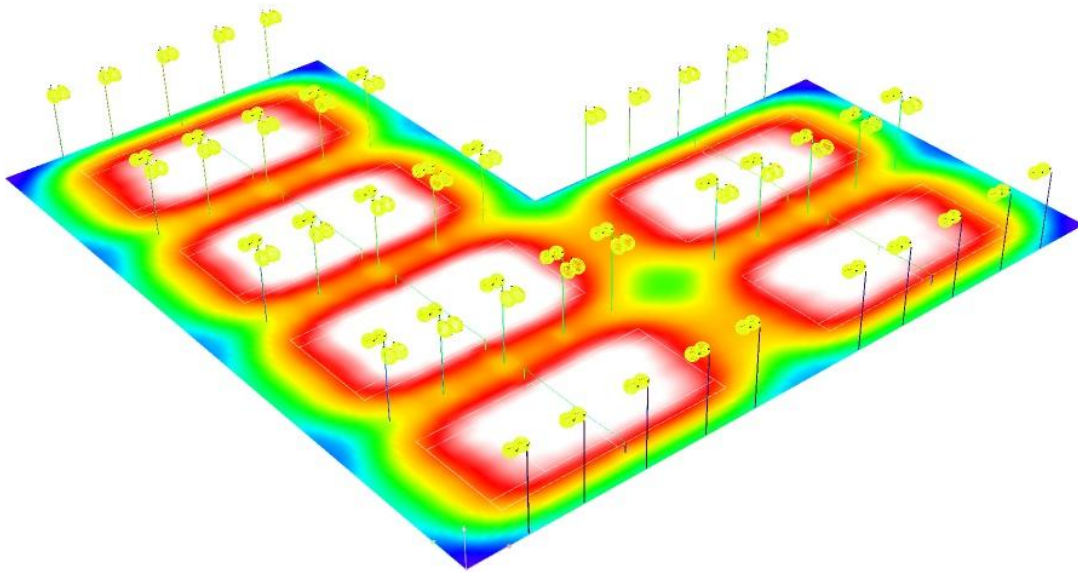

0 37.50 75 112.50 150 187.50 225 262.50 300 lx

Operator
 Telephone
 Fax
 e-Mail

Exterior Scene 1 / Ground Element 1 / Surface 1 / Isolines (E)

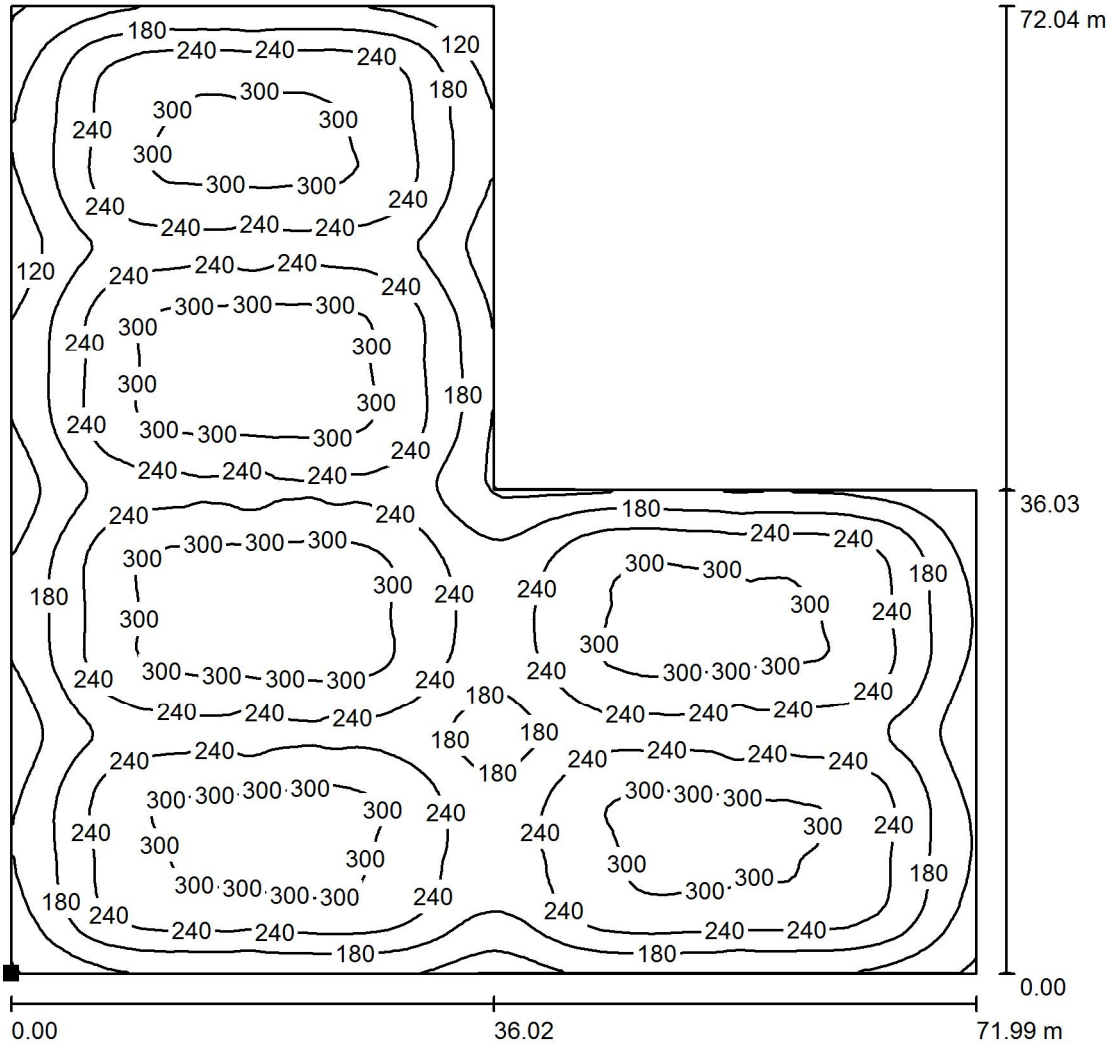

Values in Lux, Scale 1 : 564

Position of surface in external scene:
 Marked point:
 (0.000 m, 0.000 m, 0.000 m)

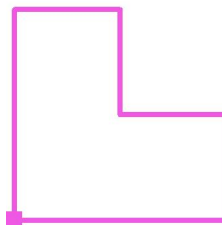

Grid: 128 x 128 Points

E_{av} [lx]	E_{min} [lx]	E_{max} [lx]	u0	E_{min} / E_{max}
237	56	329	0.237	0.171

Operator
 Telephone
 Fax
 e-Mail

Exterior Scene 1 / Calculation Grid 1 / Summary

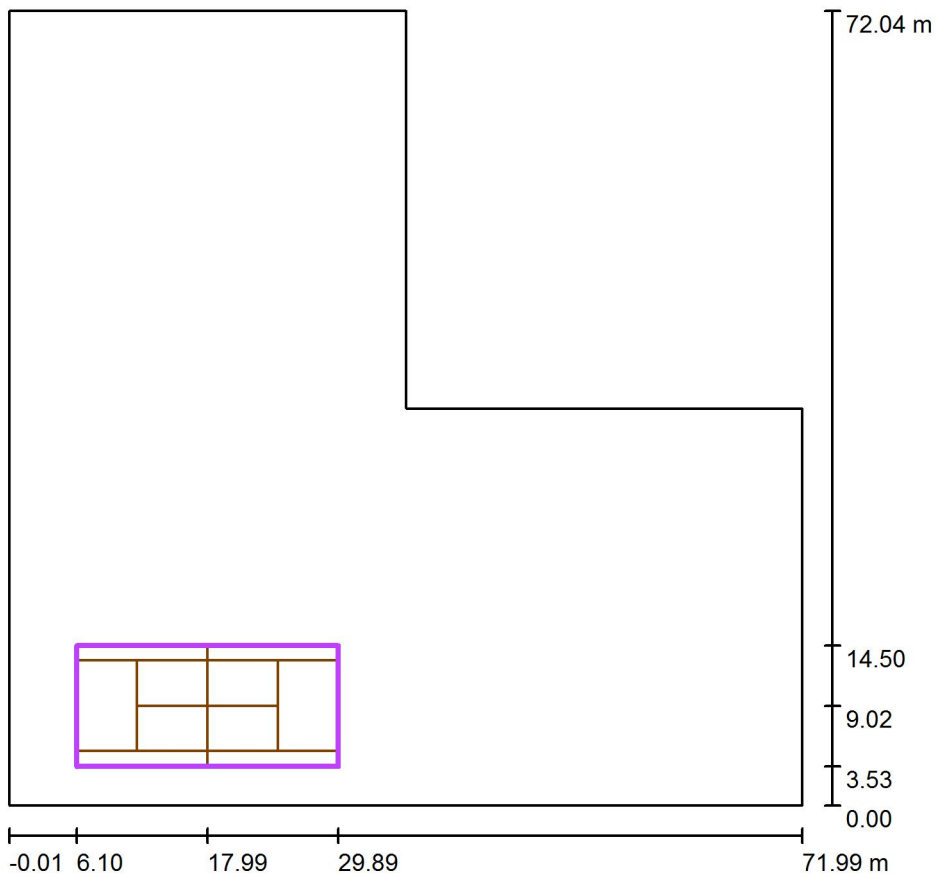

Scale 1 : 687

Position: (17.994 m, 9.016 m, 0.000 m)
 Size: (23.787 m, 10.968 m)
 Rotation: (0.0°, 0.0°, 0.0°)
 Type: Normal, Grid: 13 x 5 Points
 Belongs to the following sport arena: Tennis 1

Results overview

No.	Type	E_{av} [lx]	E_{min} [lx]	E_{max} [lx]	u0	E_{min} / E_{max}	$E_{h,m} / E_m$	H [m]	Camera
1	perpendicular	293	241	319	0.82	0.76	/	0.000	/

$E_{h,m} / E_m$ = Relationship between middle horizontal and vertical illuminance, H = Measuring Height

Operator
 Telephone
 Fax
 e-Mail

Exterior Scene 1 / Calculation Grid 2 / Summary

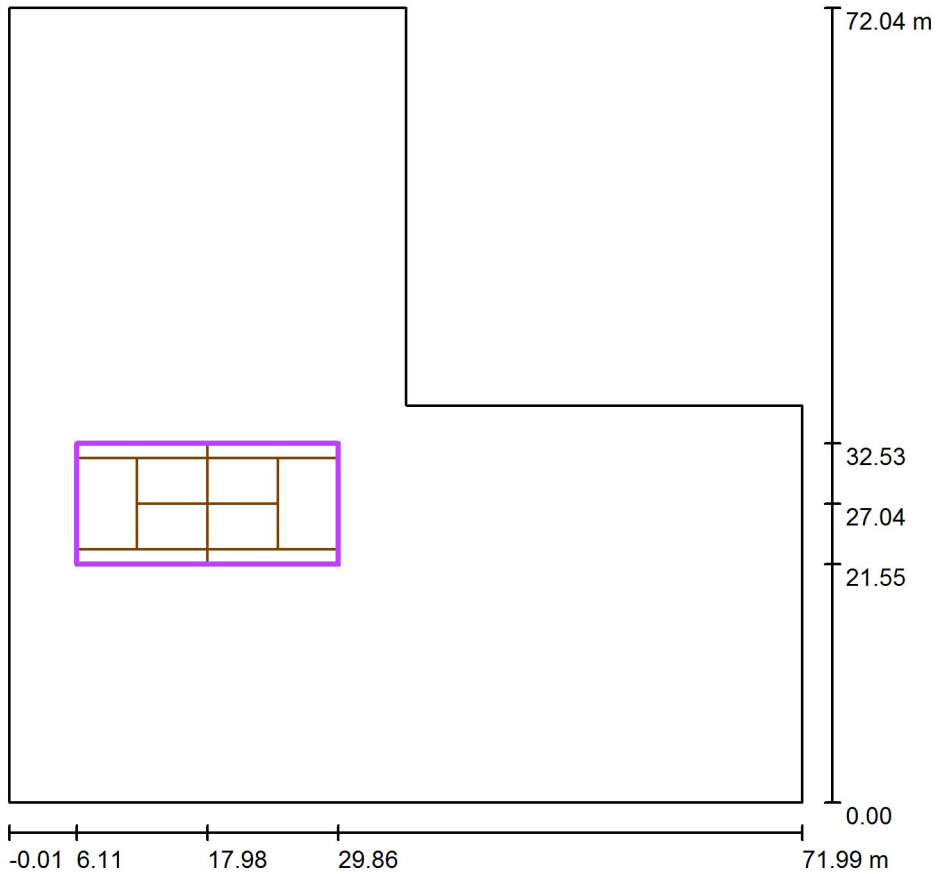

Scale 1 : 687

Position: (17.985 m, 27.040 m, 0.000 m)
 Size: (23.742 m, 10.970 m)
 Rotation: (0.0°, 0.0°, 0.0°)
 Type: Normal, Grid: 13 x 7 Points
 Belongs to the following sport arena: Tennis 2

Results overview

No.	Type	E_{av} [lx]	E_{min} [lx]	E_{max} [lx]	u0	E_{min} / E_{max}	$E_{h.m} / E_m$	H [m]	Camera
1	perpendicular	308	187	329	0.61	0.57	/	0.000	/

$E_{h.m} / E_m$ = Relationship between middle horizontal and vertical illuminance, H = Measuring Height

Operator
 Telephone
 Fax
 e-Mail

Exterior Scene 1 / Calculation Grid 3 / Summary

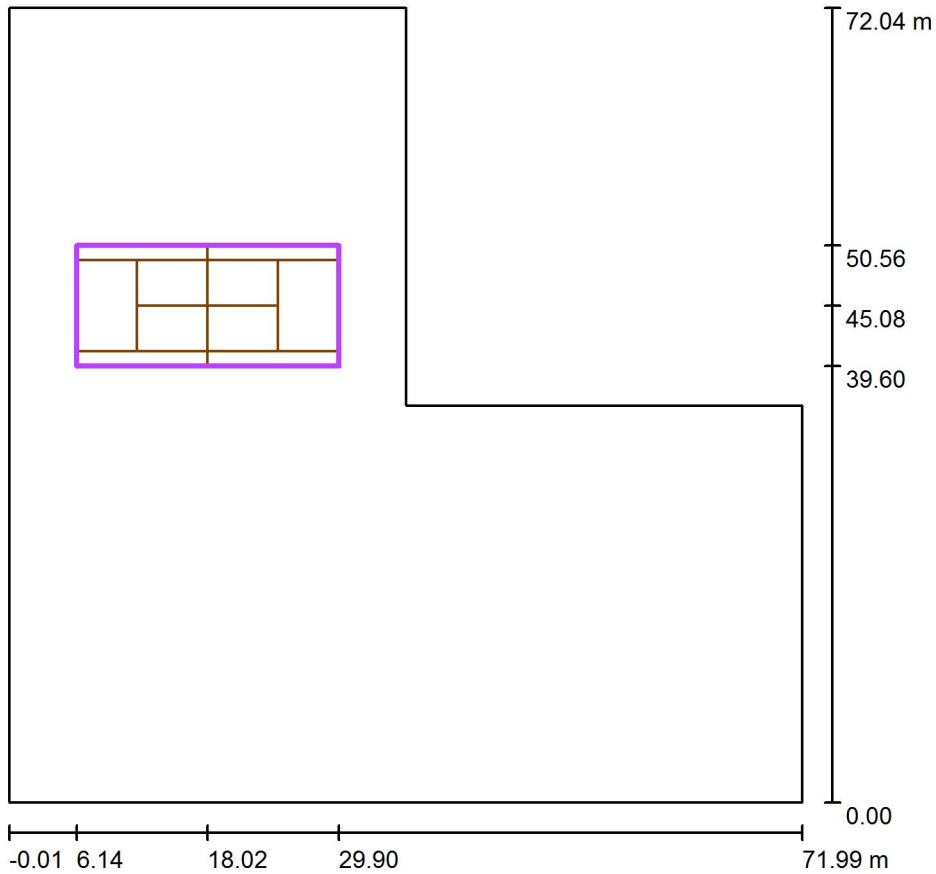

Scale 1 : 687

Position: (18.019 m, 45.078 m, 0.000 m)
 Size: (23.763 m, 10.954 m)
 Rotation: (0.0°, 0.0°, 0.0°)
 Type: Normal, Grid: 13 x 5 Points
 Belongs to the following sport arena: Tennis 3

Results overview

No.	Type	E_{av} [lx]	E_{min} [lx]	E_{max} [lx]	u0	E_{min} / E_{max}	$E_{h,m} / E_m$	H [m]	Camera
1	perpendicular	303	194	326	0.64	0.59	/	0.000	/

$E_{h,m} / E_m$ = Relationship between middle horizontal and vertical illuminance, H = Measuring Height

Operator
Telephone
Fax
e-Mail

Exterior Scene 1 / Calculation Grid 4 / Summary

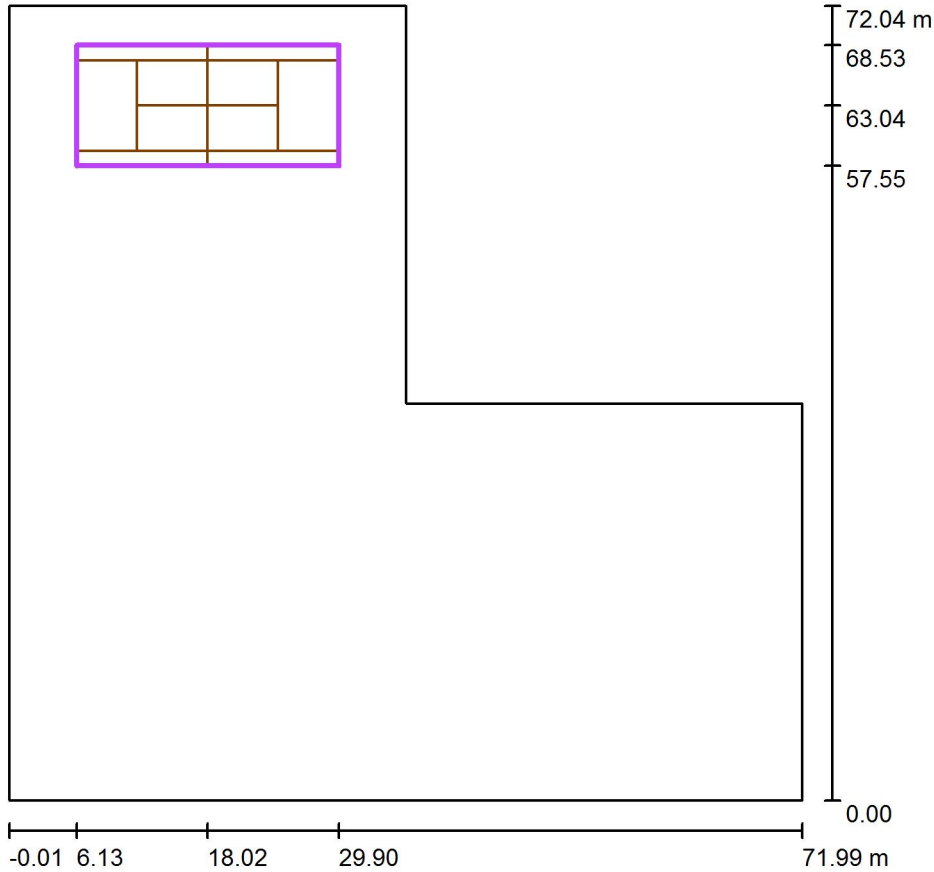

Scale 1 : 687

Position: (18.015 m, 63.042 m, 0.000 m)
 Size: (23.770 m, 10.983 m)
 Rotation: (0.0°, 0.0°, 0.0°)
 Type: Normal, Grid: 13 x 7 Points
 Belongs to the following sport arena: Tennis 4

Results overview

No.	Type	E_{av} [lx]	E_{min} [lx]	E_{max} [lx]	u0	E_{min} / E_{max}	$E_{h,m} / E_m$	H [m]	Camera
1	perpendicular	285	0.00	314	0.00	0.00	/	0.000	/

$E_{h,m} / E_m$ = Relationship between middle horizontal and vertical illuminance, H = Measuring Height

Operator
 Telephone
 Fax
 e-Mail

Exterior Scene 1 / Calculation Grid 5 / Summary

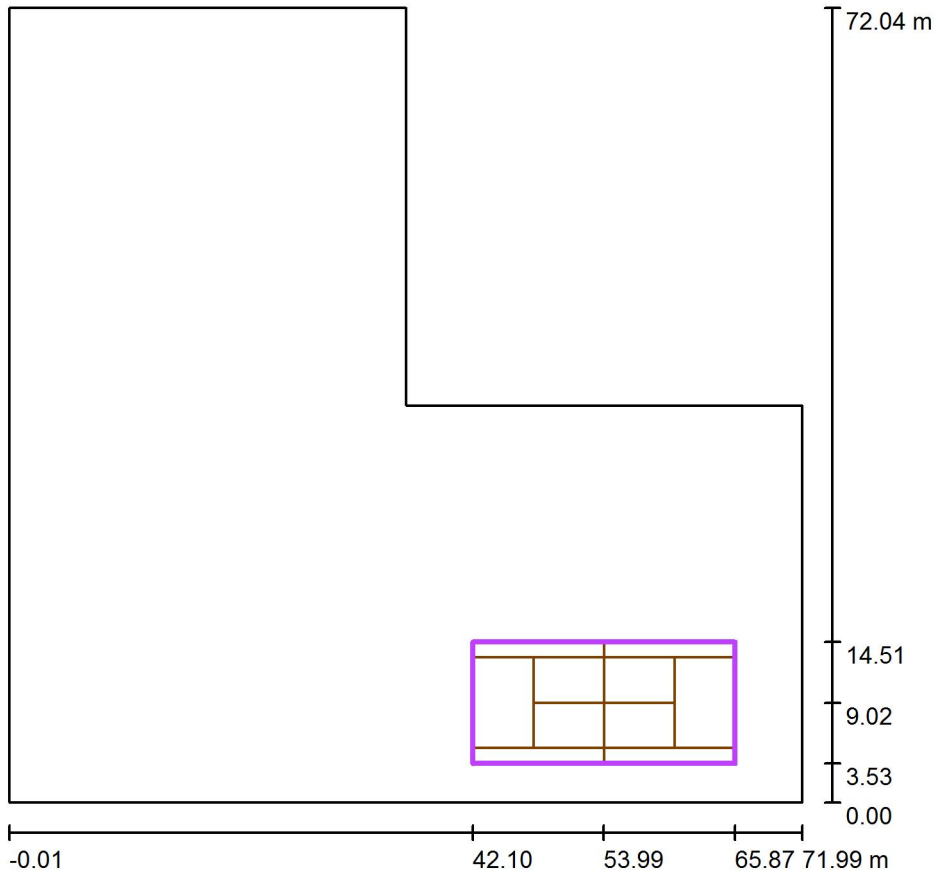

Scale 1 : 687

Position: (53.986 m, 9.022 m, 0.000 m)
 Size: (23.772 m, 10.975 m)
 Rotation: (0.0°, 0.0°, 0.0°)
 Type: Normal, Grid: 13 x 7 Points
 Belongs to the following sport arena: Tennis 5

Results overview

No.	Type	E_{av} [lx]	E_{min} [lx]	E_{max} [lx]	u0	E_{min} / E_{max}	$E_{h,m} / E_m$	H [m]	Camera
1	perpendicular	288	3.61	315	0.01	0.01	/	0.000	/

$E_{h,m} / E_m$ = Relationship between middle horizontal and vertical illuminance, H = Measuring Height

Operator
Telephone
Fax
e-Mail

Exterior Scene 1 / Calculation Grid 6 / Summary

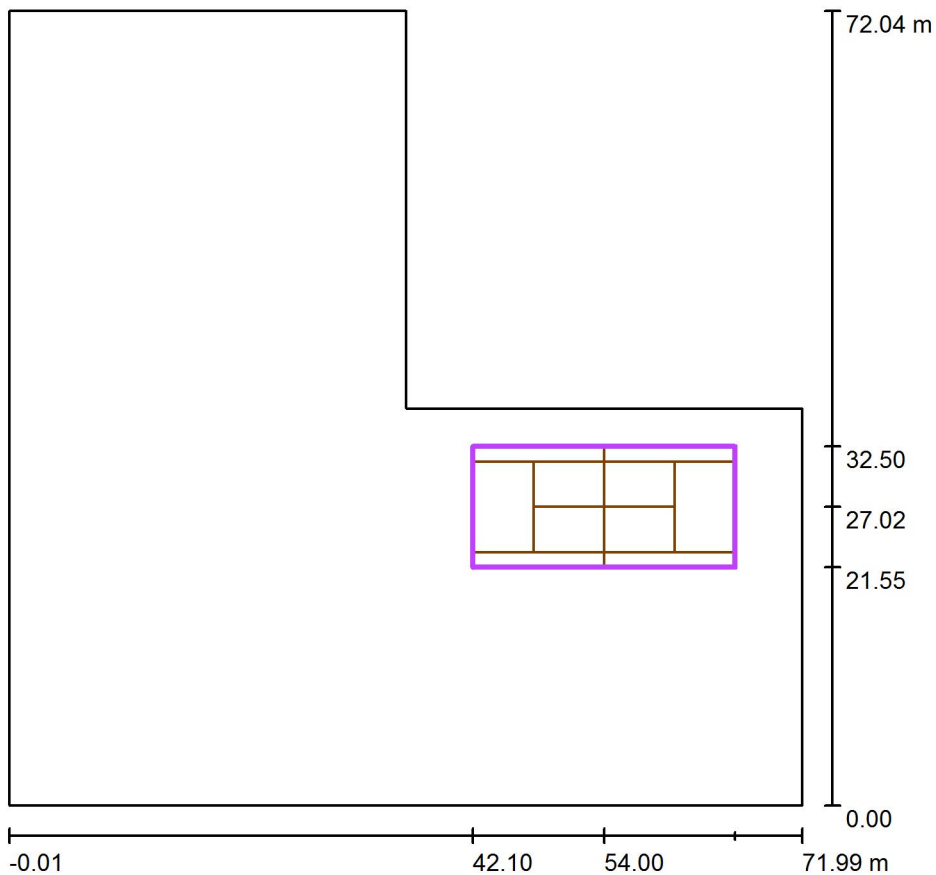

Scale 1 : 687

Position: (54.000 m, 27.023 m, 0.000 m)
 Size: (23.800 m, 10.953 m)
 Rotation: (0.0°, 0.0°, 0.0°)
 Type: Normal, Grid: 13 x 5 Points
 Belongs to the following sport arena: Tennis 6

Results overview

No.	Type	E_{av} [lx]	E_{min} [lx]	E_{max} [lx]	u0	E_{min} / E_{max}	$E_{h,m} / E_m$	H [m]	Camera
1	perpendicular	293	233	318	0.79	0.73	/	0.000	/

$E_{h,m} / E_m$ = Relationship between middle horizontal and vertical illuminance, H = Measuring Height